



6911 Marlin Circle, La Palma, CA 90623
(714) 523-8700, Fax (714) 523-3220

All work should be done by a qualified mechanic and/or per an authorized shop manual for your make and model of vehicle.

1. Remove shocks per steps outlined in your shop manual.
2. Press out the old bushings in a vice using a socket that matches the diameter of the shock eye, and one slightly smaller than the inside diameter (ID) of the shock eye.
3. Press the new polyurethane bushings into the shock eye using the same technique as when removing them. They will be tight, lubricating the bushings with a solution of soap and water will ease installation.
4. Install the proper sleeves into the eyes:
Front/Rear Top - 30mm wide sleeves (Fig 1) go into shaft end eyes.
Front/Rear Bottom - 36mm wide sleeves (Fig 2) go into body end eyes.
4. Install the shocks back onto the vehicle per shop manual.



Fig 1
30mm "narrow" sleeve



Fig 2
36mm "wide" sleeve

www.progressivesuspension.com

Copyright © 2009 by Progressive Suspension, All Rights Reserved.



6911 Marlin Circle, La Palma, CA 90623
(714) 523-8700, Fax (714) 523-3220

All work should be done by a qualified mechanic and/or per an authorized shop manual for your make and model of vehicle.

1. Remove shocks per steps outlined in your shop manual.
2. Press out the old bushings in a vice using a socket that matches the diameter of the shock eye, and one slightly smaller than the inside diameter (ID) of the shock eye.
3. Press the new polyurethane bushings into the shock eye using the same technique as when removing them. They will be tight, lubricating the bushings with a solution of soap and water will ease installation.
4. Install the proper sleeves into the eyes:
Front/Rear Top - 30mm wide sleeves (Fig 1) go into shaft end eyes.
Front/Rear Bottom - 36mm wide sleeves (Fig 2) go into body end eyes.
4. Install the shocks back onto the vehicle per shop manual.

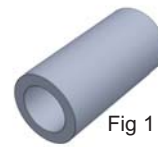

Fig 1
30mm "narrow" sleeve



Fig 2
36mm "wide" sleeve

www.progressivesuspension.com

Copyright © 2009 by Progressive Suspension, All Rights Reserved.



6911 Marlin Circle, La Palma, CA 90623
(714) 523-8700, Fax (714) 523-3220

All work should be done by a qualified mechanic and/or per an authorized shop manual for your make and model of vehicle.

1. Remove shocks per steps outlined in your shop manual.
2. Press out the old bushings in a vice using a socket that matches the diameter of the shock eye, and one slightly smaller than the inside diameter (ID) of the shock eye.
3. Press the new polyurethane bushings into the shock eye using the same technique as when removing them. They will be tight, lubricating the bushings with a solution of soap and water will ease installation.
4. Install the proper sleeves into the eyes:
Front/Rear Top - 30mm wide sleeves (Fig 1) go into shaft end eyes.
Front/Rear Bottom - 36mm wide sleeves (Fig 2) go into body end eyes.
4. Install the shocks back onto the vehicle per shop manual.



Fig 1
30mm "narrow" sleeve



Fig 2
36mm "wide" sleeve

www.progressivesuspension.com

Copyright © 2009 by Progressive Suspension, All Rights Reserved.



6911 Marlin Circle, La Palma, CA 90623
(714) 523-8700, Fax (714) 523-3220

All work should be done by a qualified mechanic and/or per an authorized shop manual for your make and model of vehicle.

1. Remove shocks per steps outlined in your shop manual.
2. Press out the old bushings in a vice using a socket that matches the diameter of the shock eye, and one slightly smaller than the inside diameter (ID) of the shock eye.
3. Press the new polyurethane bushings into the shock eye using the same technique as when removing them. They will be tight, lubricating the bushings with a solution of soap and water will ease installation.
4. Install the proper sleeves into the eyes:
Front/Rear Top - 30mm wide sleeves (Fig 1) go into shaft end eyes.
Front/Rear Bottom - 36mm wide sleeves (Fig 2) go into body end eyes.
4. Install the shocks back onto the vehicle per shop manual.

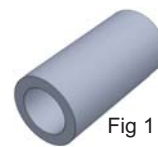

Fig 1
30mm "narrow" sleeve



Fig 2
36mm "wide" sleeve

www.progressivesuspension.com

Copyright © 2009 by Progressive Suspension, All Rights Reserved.